



**PREACH**

**O**

**MATIC**

**PICS +**

**BLUEPRINTS**

OPEN AIR CAMPAIGNERS

PO Box D ♦ Nazareth ♦ PA ♦ 18064

Phone: (610) 746-0508 ♦ Fax: (888) 886-5661

Email: [usa@oaci.org](mailto:usa@oaci.org) ♦ Web: [www.oaci.org](http://www.oaci.org)

1- 4x8 1/2" ply  
1- 4x4 1/4" ply

ALL 1X? TO BE POPLAR OR HAWKWOOD

# MAIN BOX

1/2" Birch ply

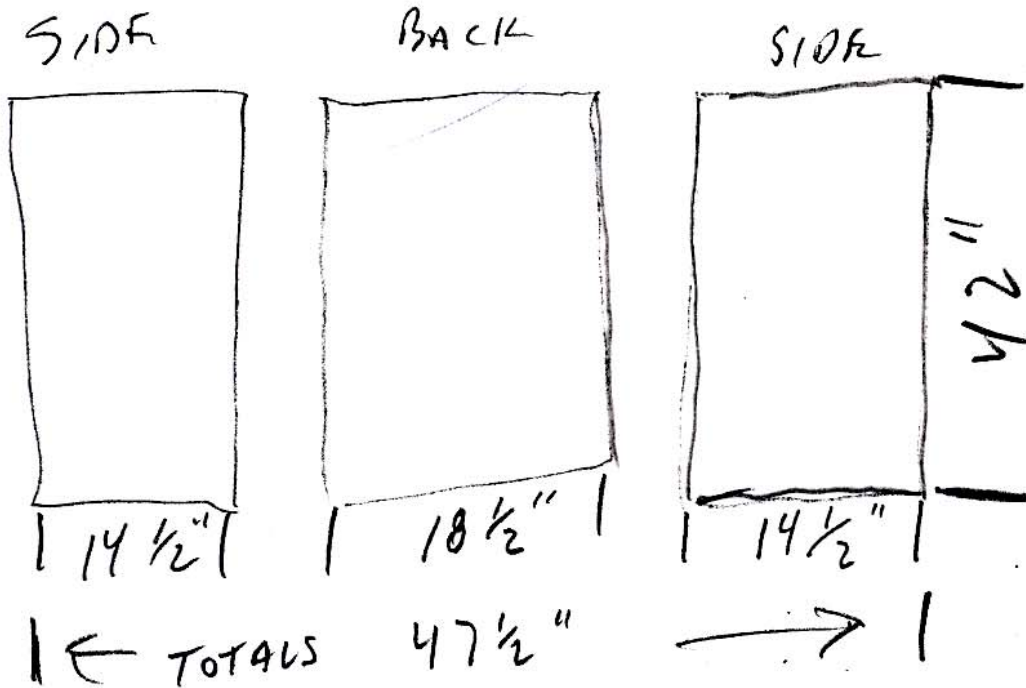

TOP SHELF -  
(SEE DETAIL)

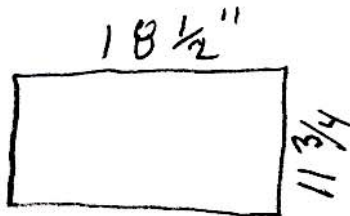

PAINT SHELF  
(SEE DETAIL)

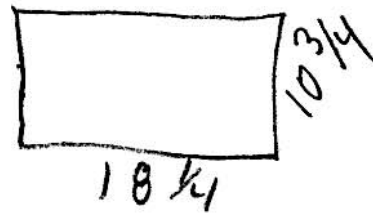

MID SHELF

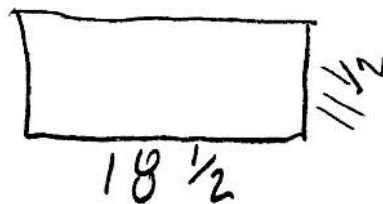

BOTTOM  
(SEE DETAIL)

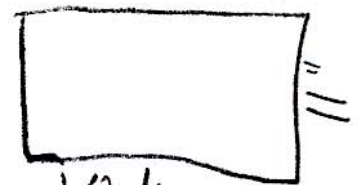

1/4" THICK

SHELF DETAIL SHEET

TOP SHELF

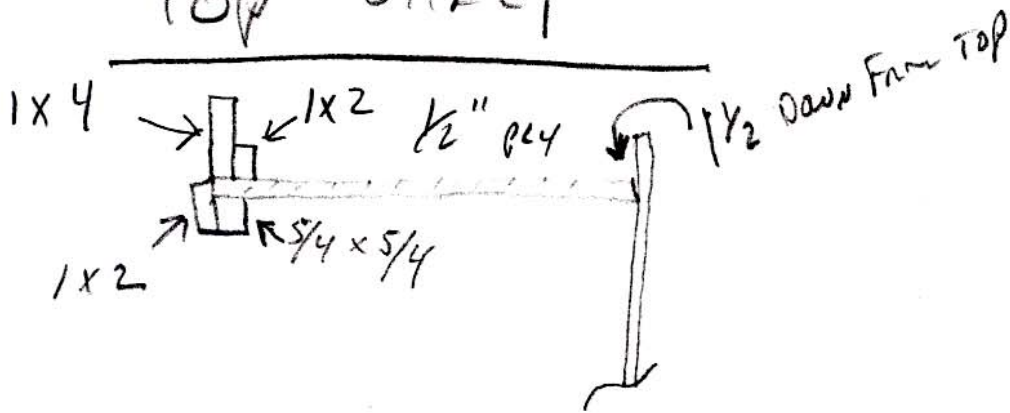

PAINT SHELF

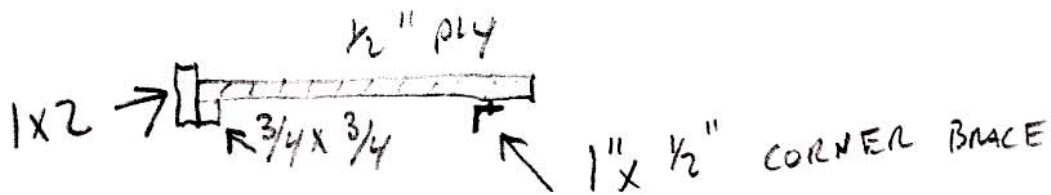

1 ON EACH SIDE  
1" FROM BACK 3/4" FROM SIDE  
USING 1/2" SCREWS

BOTTOM SHELF

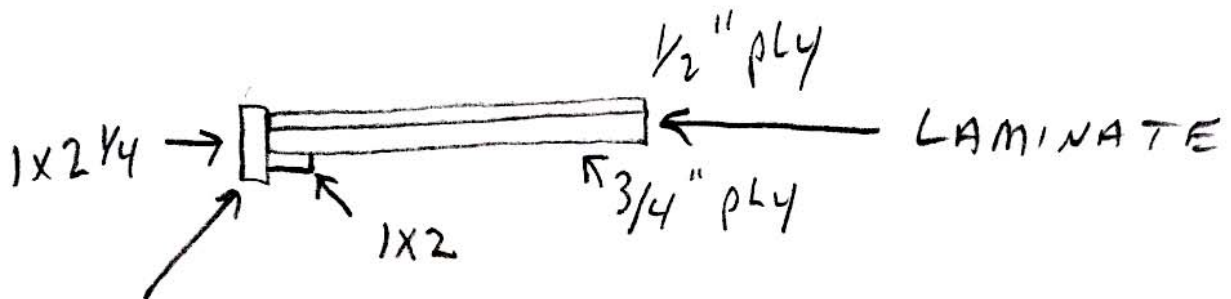

INSTALL 3"  
MENDING PLATES  
ON EACH END TO

# POSITIONING OF SHELVES TO MAIN BOX

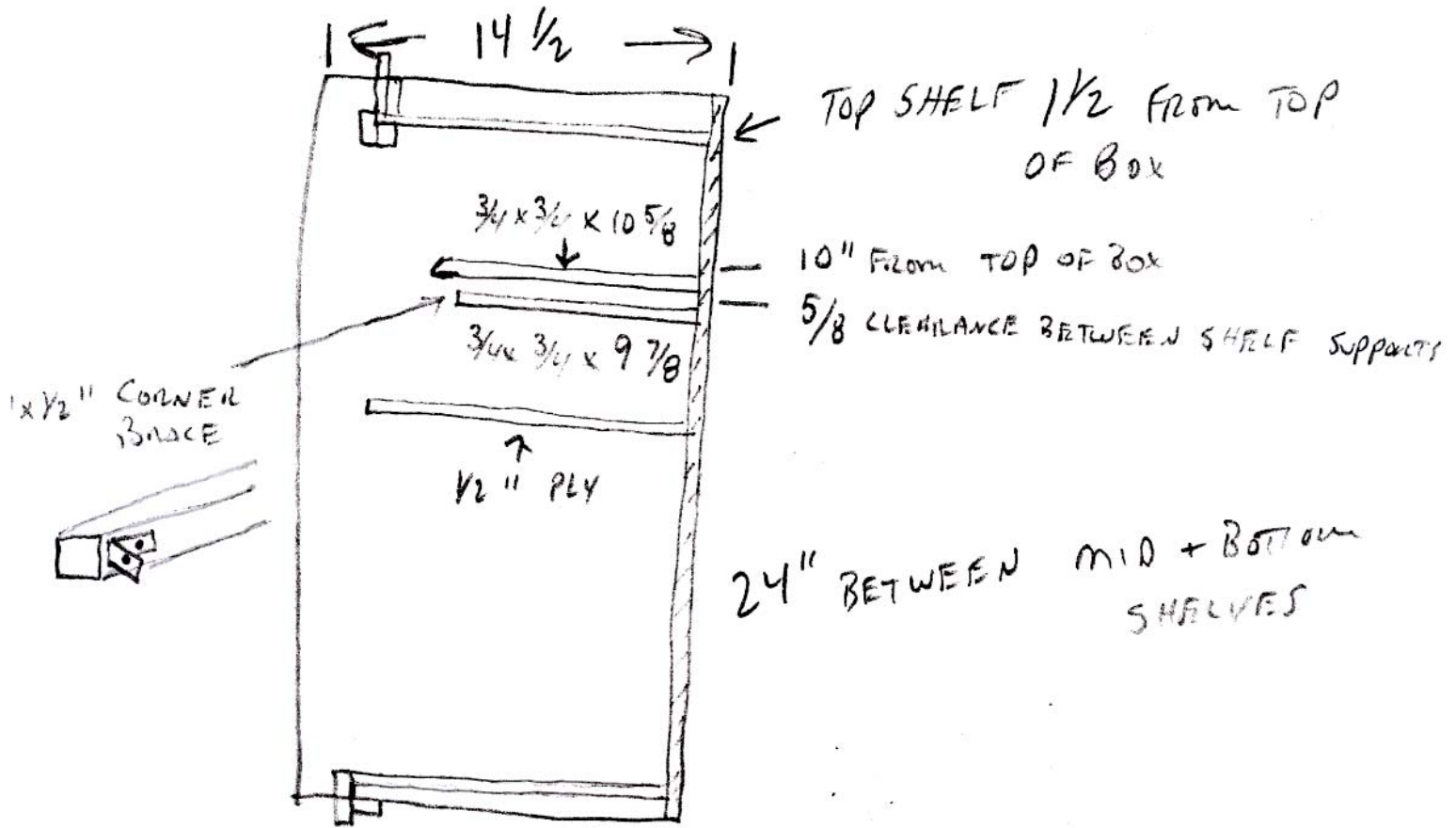

# SKETCH BOARD PANELS

1/4" BIRCH

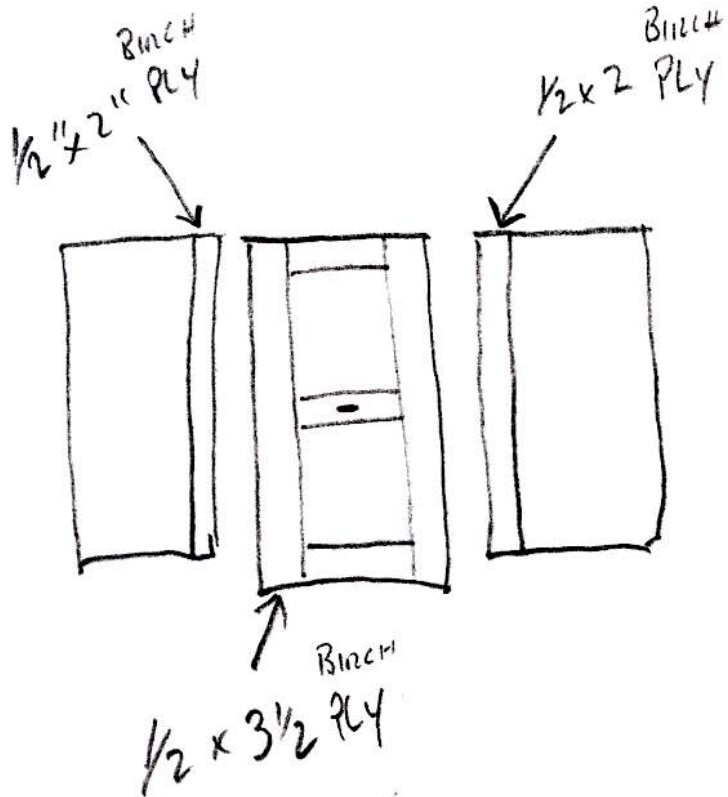
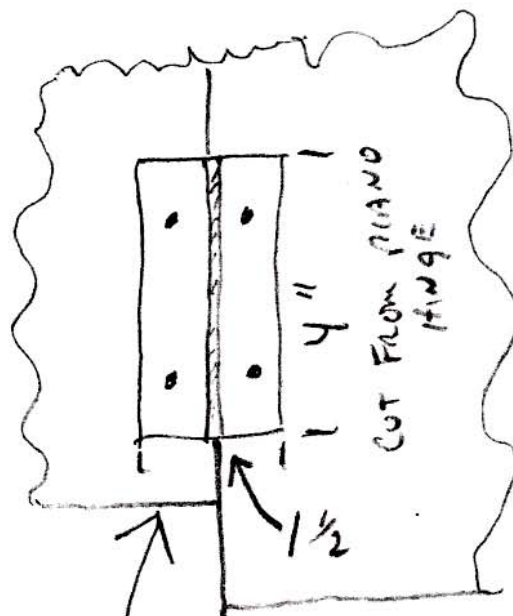
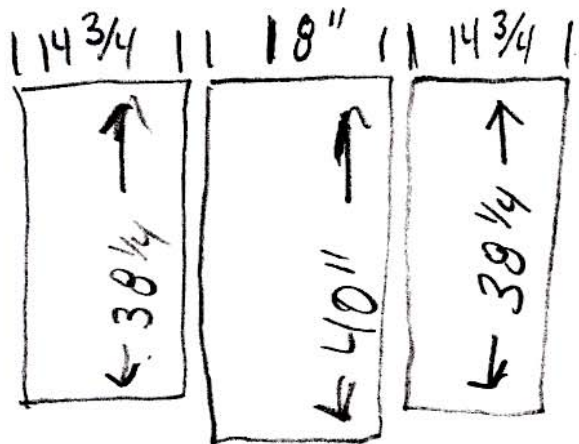

LAMINATE 1/2" STRIPS TO 1/4" PANELS

# SKETCH BOARD PANELS

## HARDWARE PLACEMENT

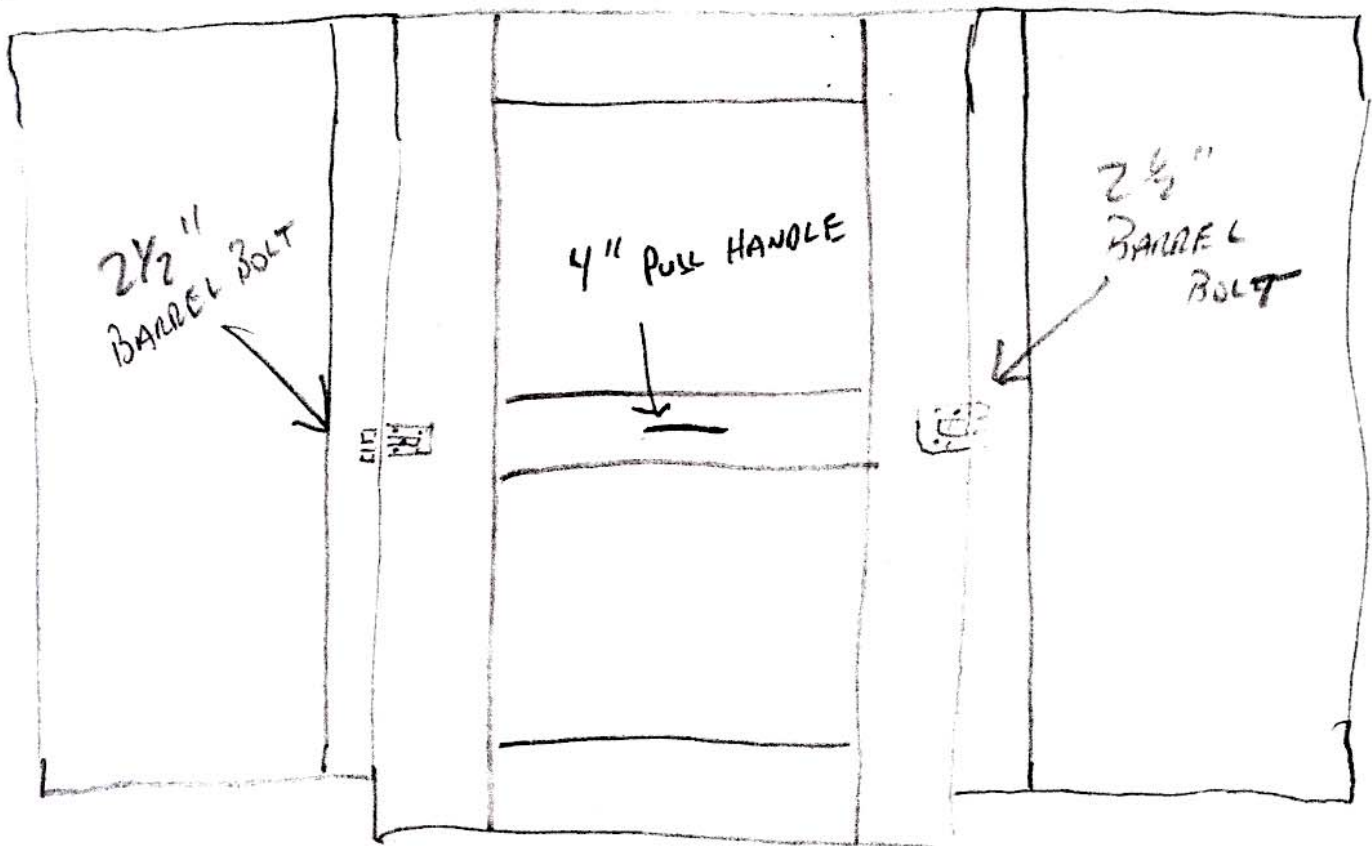
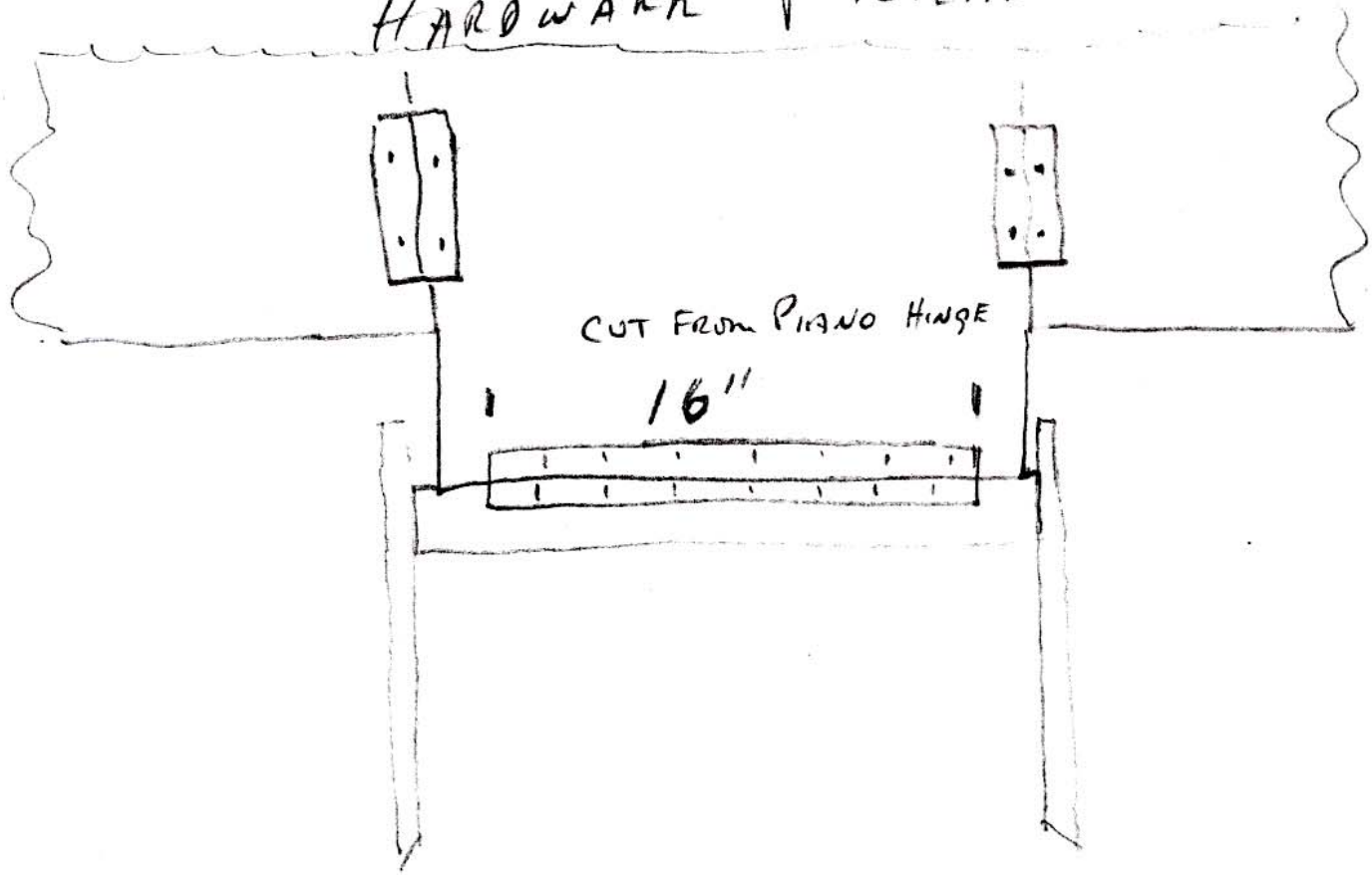

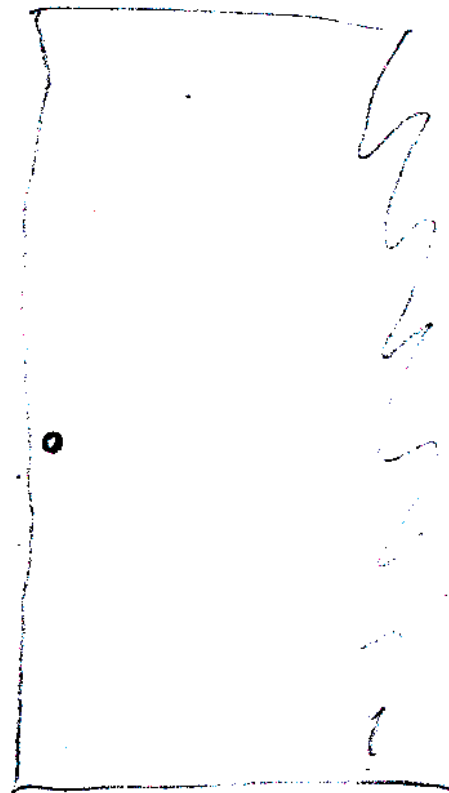
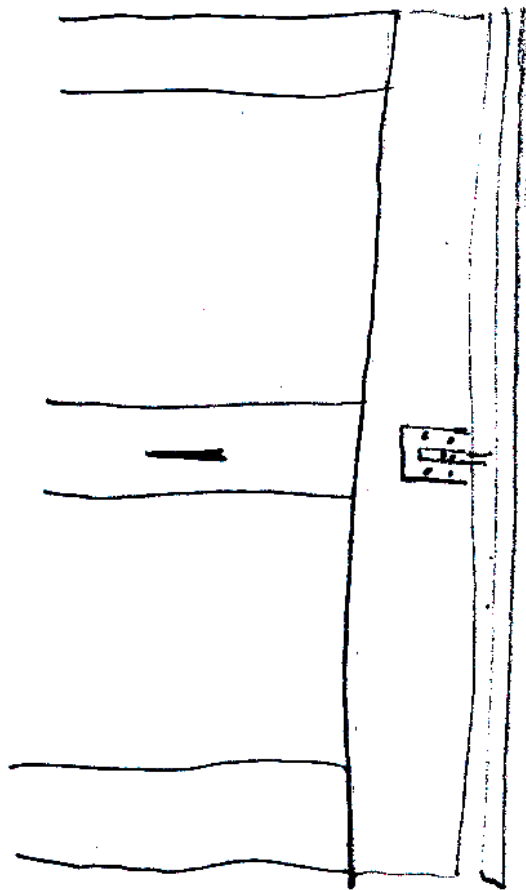

SEE PHOTO FOR HOLE  
PLACEMENT IN SIDE PANEL  
TO RELIEVE BARREL BOLT

# WING STABILIZER

SOME TYPE OF WING STABILIZER IS

ABSOLUTELY NECESSARY

MATERIAL FROM  $\frac{1}{2}$ " CONDUIT +  $\frac{3}{4}$ " FLAT STOCK  
30" LONG

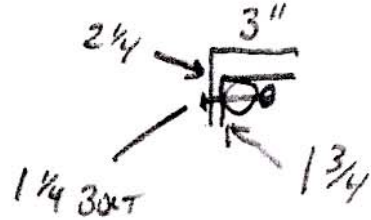

WHEN NOT IN USE THIS CAN  
BE STORED TO BACK OF BOX  
USING MEDIUM GRIP CLIP ORGANIZERS  
FASTENED W/  $\frac{1}{2}$ " SCREWS  
(SEE PHOTO ON POM SETUP)

# BUNGEE'S

1 - 10" MINI BUNGEE TO HOLD  
WINGS IN PLACE WHILE RAISING + LOWER  
SKETCH BOARD (SEE PHOTO ON POM SETUP)

1 - 18" BUNGEE TO KEEP SKETCH BOARD IN  
UPRIGHT POSITION (SEE PHOTO ON POM SETUP)

2 - ADJUSTABLE  
6" TO 48" BUNGEE'S (SEE PHOTO ON POM SETUP)



# VENEER EDGING

TOPS OF 3 BOX PANELS  
+ FRONT EDGES OF SIDE PANELS  
CAN BE VENEERED WITH  
PRE-GLUED IRON ON VENEER EDGING

---

## CORNER PROTECTORS

9/16 x 1/4 BRASS CORNER PROTECTORS  
ON ALL EXPOSED OUTSIDE CORNERS  
NOT REQUIRED BUT RECOMMENDED

---

SEE PHOTOS FOR DETAILS ON <sup>38" W/CAP</sup> PVC <sub>SCHED. 20</sub>  
MOUNTING BOX TO DOLLY  
USING 1/2" x 3" U BOLTS (BACK)  
1/4" MOD TRUSS SELF DRILL  
SCREWS

+ 4" PAPER TUBE  
↓  
ATTACHED TO DOLLY  
USING 2-24" ONLY  
CABLE TIES













***For a complete  
listing of open-air  
supplies  
including paints,  
brushes, sketch  
board and object  
lessons, contact  
our office below.***

